

Ride distributed by:  
 Zamperla SPA  
 Via Mte Grappa 15/17  
 36077 Altavilla Vic.na  
 ITALY  
 Phone: +39 0444 998 400  
 Fax: +39 0444 573 720 - e.mail: zamperla@zamperla.it



Bulletin No: 2009 RCTC-02
Release Date: June 18, 2009
Effective Date: June 18, 2009
Supersedes:
Completion Date: Immediately
Page: 1 of 2

## SAFETY ALERT

Ride Manufacturer: A. Zamperla SpA	Affected Production Dates: All
Ride Name: Twister Coaster	Affected Serial Nos.: All
Model Number: Twister Coaster	

**Abstract Of Issue:**  
 Emphasis on importance of inspection of front and rear axles, part number 9476027035A.

**Reason For Release:**  
 An axle failed during operation. To reinforce the need for routine lubrication and non-destructive testing (NDT) of axles.

**Action To Be Taken:**  
 If NDT by means of dye penetrant testing (PT) has not been performed prior to the 2009 operating season, or it has been longer than 3,000 operation hours or 72,000 ride cycles since the last NDT was performed on the axles (part number 9476027035A), then this preventive maintenance must be completed prior to further operation of the axles.

**Detail Of Issue:**  
 Preventive maintenance on the axles is critical. Emphasis of inspections needs to be placed in all changes in diameter with highest attention in the area where the axle changes from 50mm in diameter to 70mm. Routine, monthly lubrication of axles as indicated on page 6-40 (page 6-41 in some manuals) in the manual needs to be strictly adhered.

**Future Action To Be Taken:**

In addition to the PT performed on the axles, a close visual inspection of the axle must be performed on the axles every time the PT is performed. Emphasis of inspections needs to be placed in all changes in diameter with highest attention in the area where the axle changes from 50mm in diameter to 70mm.

If any notches, imperfections, unusual wear are noted on the axles, remove axle from operation and send photographs to Zamperla immediately. Zamperla will advise on how to proceed.

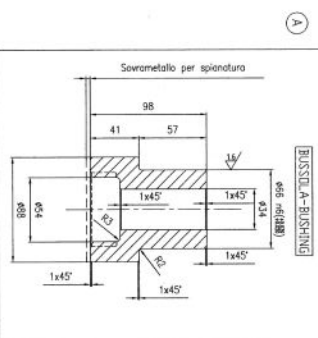
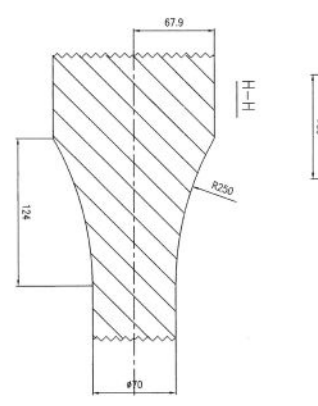
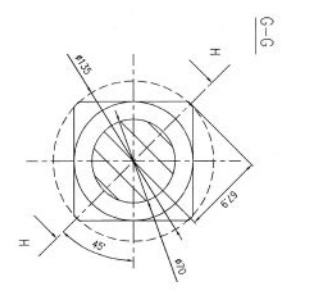
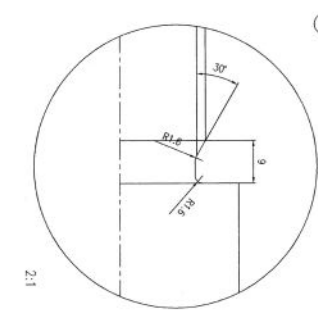
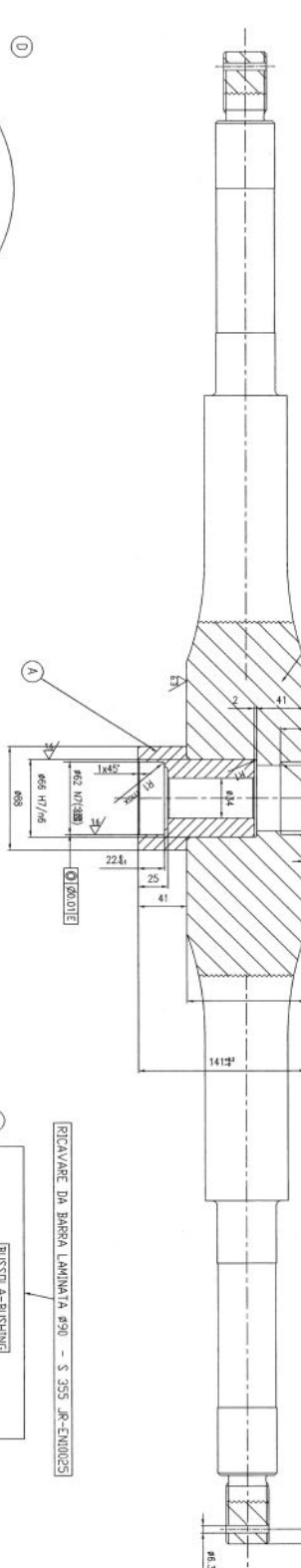
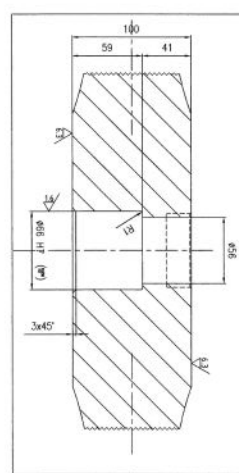
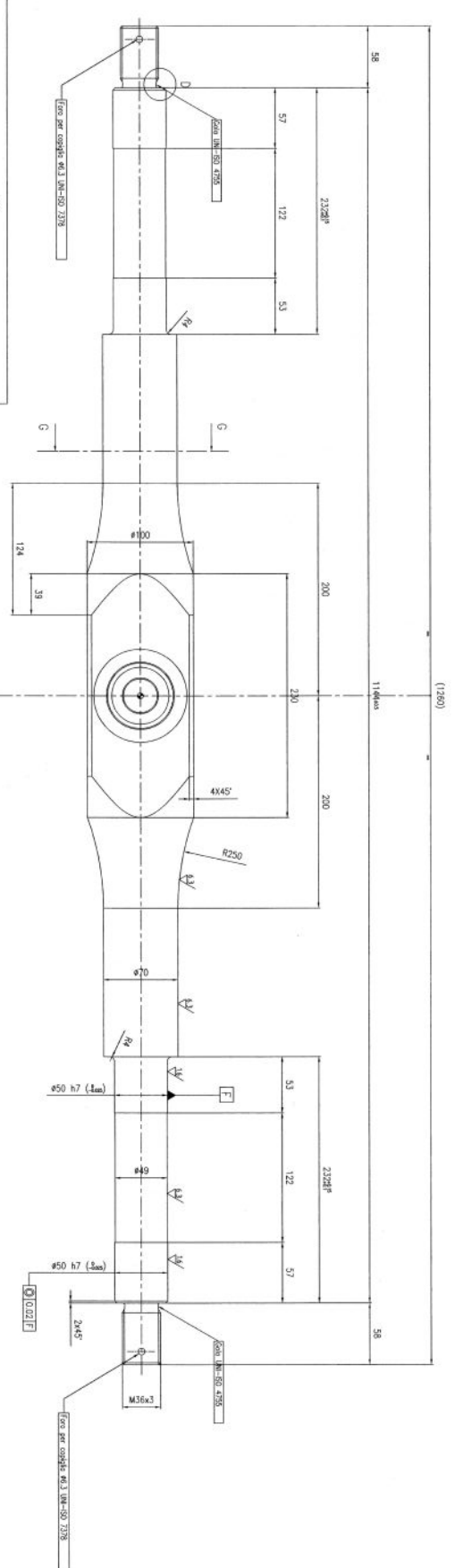

RICAVARE DA BARRA LAMINATA Ø90 - S 355 JR-EN10025

BUSO A-BUSHING

- CICLO DI LAVORI:**
- 1) BARRA LAMINATA Ø135 SECONDO EN 10083/1
  - 2) CONTROLLO UT
  - 3) SGROSSATURA
  - 4) BENEFICA
  - 5) PROVE MECCANICHE SU PROVETTA RICAVATA DA PRODOTTO IN SECONDA
  - 6) FINITURA A LAVORAZIONE SEMI CISCINETTI
- WORKING CYCLE:**
- 1) ROLLED SECTION Ø135 EN 10083/1
  - 2) UT EXAMINATION
  - 3) ROUGH MACHINING
  - 4) HARDENING & TEMPERING
  - 5) RESTRICTIVE TEST ON TEST PIECE
  - 6) PRESS FIT BUSHING SECTION Ø90mm.
  - 7) FINISHING AND MACHINE BEARING SEAT

2.0 001 081778

Peso kg 4,0

<b>AVANTIPERMA</b> INDUSTRIA ITALIANA PER LA REALIZZAZIONE DI COMPONENTI PER MACCHINE STRUMENTI E ATTREZZATURE PER LAVORAZIONE	
VIA S. GIUSEPPE 10 03703 ZEPHIRINO (VT)	TEL. 0761/200511 FAX 0761/200512 E-MAIL: info@avanti-perma.it
03703 ZEPHIRINO (VT)	03703 ZEPHIRINO (VT)